

Product Portfolio

FUCHS MATERIAL HANDLERS



FUCHS[®]

A TEREX BRAND

MHL



| | MHL310 | MHL320 MODULAR+ | MHL331 | MHL335 | MHL340 |
|--|------------|--------------------|------------|------------|------------|
| | 114 hp | 127 hp | 154 hp | 154 hp | 173 hp |
| | ■ | 127 hp | 154 hp | 154 hp | 171 hp |
| | 75 kW | 75 kW | 90 kW | 90 kW | 110 kW |
| | 37,699 lbs | 46,297 lbs | 53,351 lbs | 56,217 lbs | 67,461 lbs |
| | 29'6" | 34'1" | 39'4" | 39'4" | 44'11" |



| | MHL345 | MHL350 | MHL355 | MHL360 | MHL365 |
|--|------------|------------|------------|-------------|-------------|
| | 173 hp | 215 hp | 215 hp | 255 hp | 255 hp |
| | 171 hp | 198 hp | 198 hp | 250 hp | 250 hp |
| | 110 kW | 132 kW | 132 kW | 160 kW | 160 kW |
| | 68,784 lbs | 78,264 lbs | 90,169 lbs | 107,585 lbs | 114,200 lbs |
| | 44'11" | 52'5" | 52'5" | 59' | 59' |

MHL



| | MHL420 | MHL434 | MHL354 | MHL364 | MHL450 |
|--|--------------|------------|------------|-------------|------------|
| | 127 / 130 hp | 154 hp | 215 hp | 255 hp | 241 hp |
| | 127 hp | 154 hp | 198 hp | 250 hp | 244 hp |
| | 48,950 lbs | 56,659 lbs | 76,941 lbs | 106,042 lbs | 84,658 lbs |
| | 41'12" | 35'1" | 37'1" | 39'8" | 52'6" |

RHL



| | RHL320 | RHL331 | RHL340 | RHL350 | RHL360 |
|--|------------|------------|------------|------------|-------------|
| | 127 hp | 154 hp | 173 hp | 215 hp | 255 hp |
| | 127 hp | 154 hp | 171 hp | 198 hp | 250 hp |
| | 75 kW | 90 kW | 110 kW | 132 kW | 160 kW |
| | 62,831 lbs | 63,934 lbs | 83,775 lbs | 94,798 lbs | 119,049 lbs |
| | 34'1" | 39'4" | 44'11" | 52'5" | 59' |

FQC



| | FQC340* | FQC350* |
|--|------------|------------|
| | 173 hp | 215 hp |
| | 171 hp | 198 hp |
| | 110 kW | 132 kW |
| | 65,697 lbs | 78,264 lbs |
| | 36'1" | 42'7" |

* More FQC models upon request

** Basic machine
(with stick head and without attachment)

MQC



| | MQC345* | MQC350* |
|--|------------|------------|
| | 173 hp | 215 hp |
| | 171 hp | 198 hp |
| | 110 kW | 132 kW |
| | 70,547 lbs | 75,839 lbs |
| | 41'4" | 49'2" |

* More MQC models upon request

BQC



| | BQC355* |
|--|------------|
| | 215 hp |
| | 198 hp |
| | 132 kW |
| | 90,169 lbs |
| | 52'5" |

* More BQC models upon request



**Let's
handle
it!**

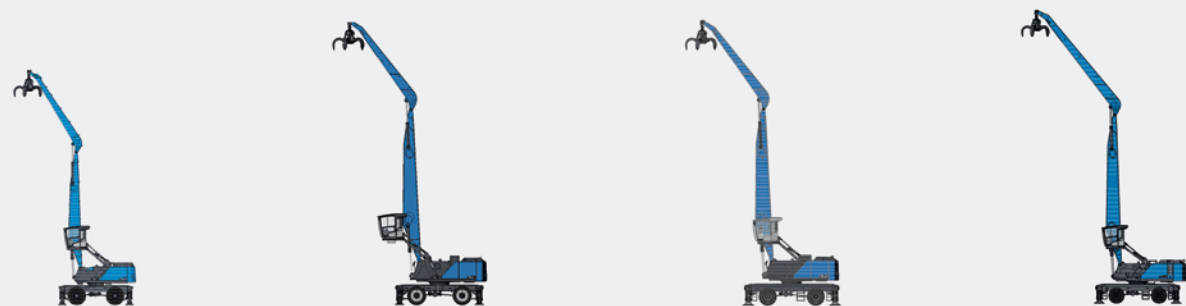

MHL370 **MHL375** **MHL380** **MHL390**

| | | | | |
|--|-------------|-------------|-------------|-------------|
| | 308 hp | 328 hp | 328 hp | 402 hp |
| | 308 hp | 328 hp | 328 hp | 366 hp |
| | 200 kW | 220 kW | 220 kW | 250 kW |
| | 114,640 lbs | 146,607 lbs | 158,300 lbs | 191,802 lbs |
| | 59' | 65'7" | 72'2" | 80'4" |



MHL360 PYLON (2'7") **MHL365 PYLON (4'7")**

| | | |
|--|-------------|-------------|
| | 255 hp | 255 hp |
| | 250 hp | 250 hp |
| | 160 kW | 160 kW |
| | 110,451 lbs | 122,356 lbs |
| | 59' | 59' |



PYLON-MOUNTED MACHINES

As an option every Fuchs machine can be equipped with a pylon.

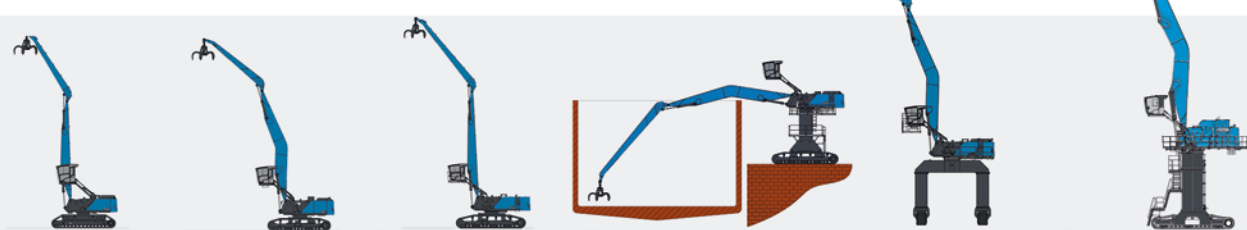

RHL370 **RHL380** **RHL390** **RHL390 XL** **RHL390 GANTRY** **F120MH**

| | | | | | | |
|--|-------------|-------------|-------------|-------------|-------------|---------------------------------------|
| | 308 hp | 328 hp | 402 hp | 402 hp | 402 hp | 469 hp + 201 hp Blue Hybrid System |
| | 308 hp | 328 hp | 366 hp | 366 hp | 366 hp | 469 hp + 201 hp Blue Hybrid System |
| | 200 kW | 220 kW | 250 kW | 250 kW | 250 kW | 280 kW + 150 kW Blue Hybrid System |
| | 121,254 lbs | 169,756 lbs | 211,644 lbs | 231,485 lbs | 242,508 lbs | 330,700 lbs |
| | 59' | 72'2" | 80'4" | 80'4" | 80'4" | 88'6" |

AHL

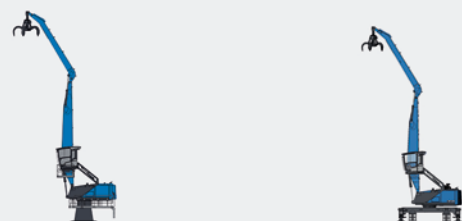

AHL350 PYLON* **AHL350 STANDARD***

| | | |
|--|------------|------------|
| | 215 hp | 215 hp |
| | 198 hp | 198 hp |
| | 132 kW | 132 kW |
| | 56,217 lbs | 78,264 lbs |
| | 52'5" | 52'5" |

* More AHL models upon request

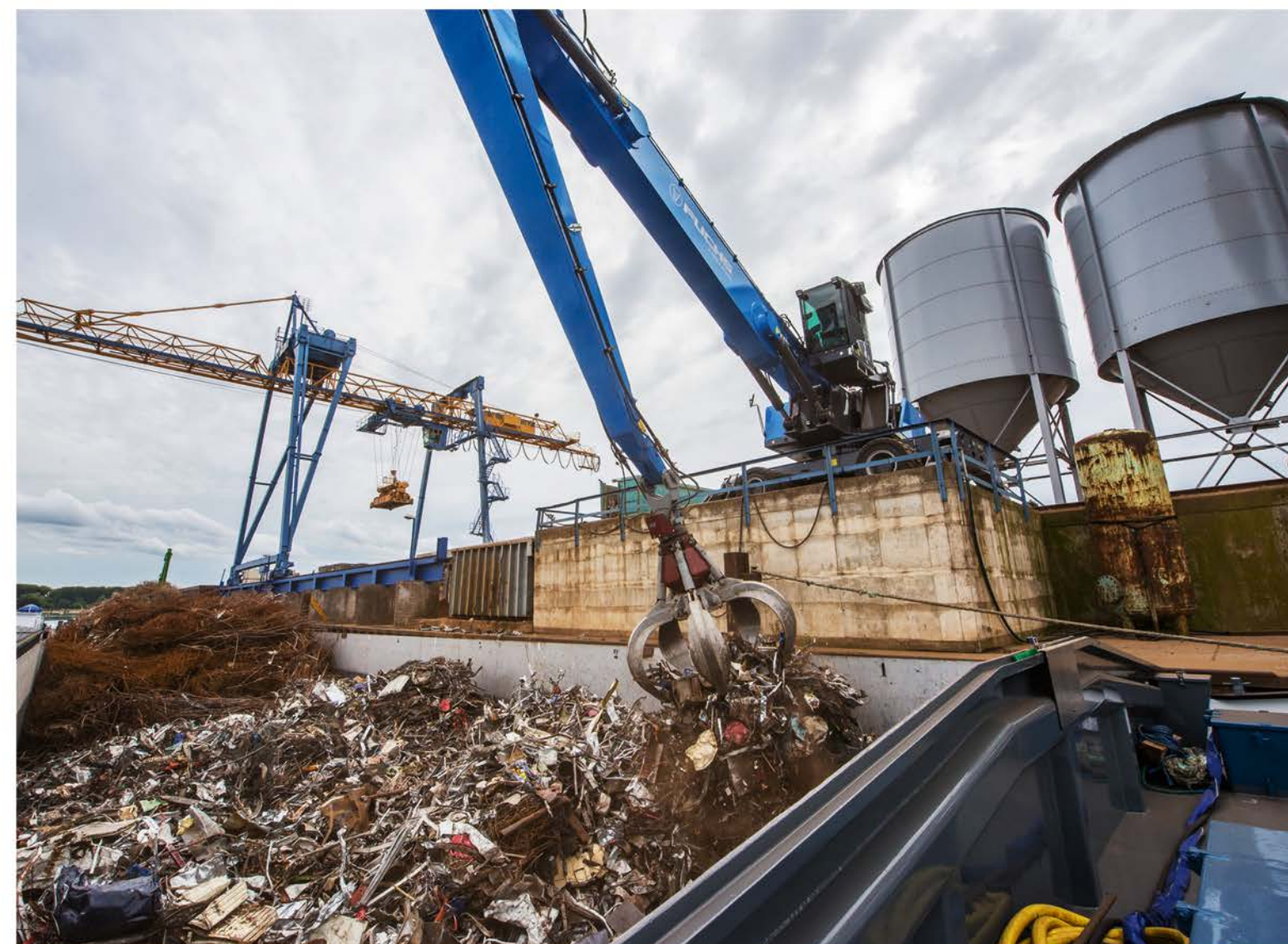

Key



Engine power
U.S. Tier 4/ EU Stage V



Engine power
U.S. Tier 3/ EU Stage IIIA



Electric motor



Max. service weight
without attachments



Max. reach

MODULAR SYSTEM

ATTACHMENTS



Cactus grab



Timber grapple

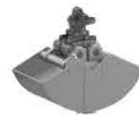

Clamshell grab



Sorting grapple



Magnet plate



Load hook

WORK EQUIPMENT

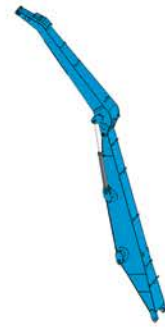

Straight

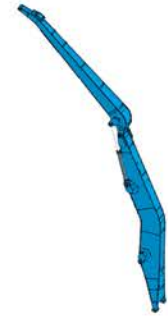

Banana boom



Universal stick



FQC
Fuchs QuickConnect



MQC
Multi QuickConnect



BQC
Boom QuickConnect

CAB SYSTEMS



Vertically adjustable



Vertically and horizontally adjustable

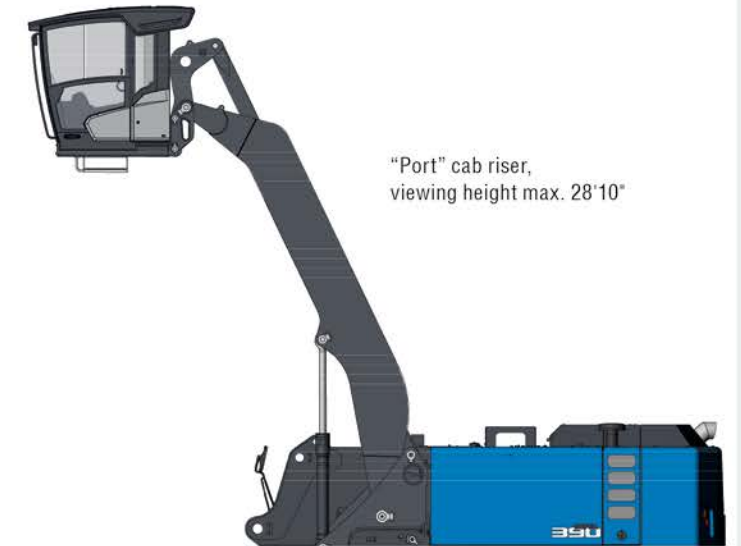

"Port" cab riser, viewing height max. 28'10"

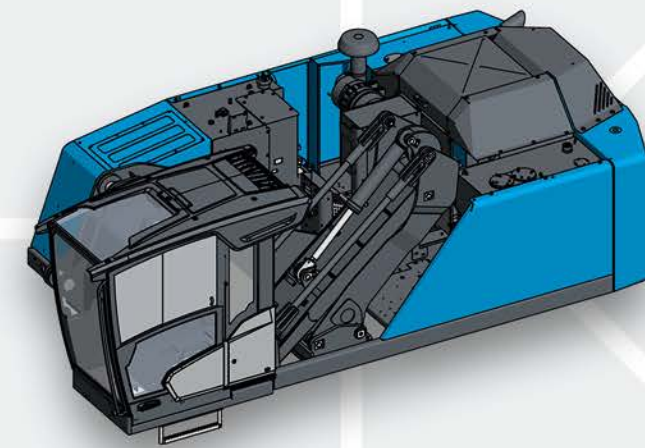

ENGINES

Diesel engine

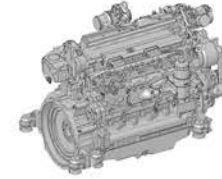

Electric motor



OPTIONS

Cable reel



Cable drum

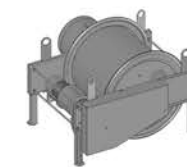

UNDERCARRIAGES



Standard-undercarriage



Standard-undercarriage

2'7"



XL-undercarriage

4'7"



Crawler



Crawler

2'7"



Crawler: XL-undercarriage

12'2"

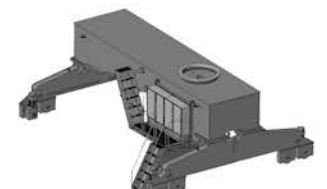

Rail undercarriage



AHL Pylon

2'-9'10"

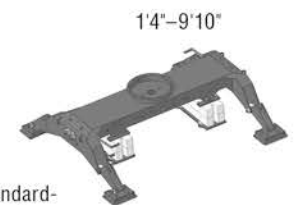

AHL Standard-undercarriage

1'4"-9'10"

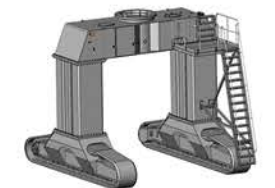

Gantry



www.terex.com/fuchs

April 2023. Product specifications and prices are subject to change without notice or obligation. The photographs and/or drawings in this document are for illustrative purposes only. Refer to the appropriate Operator's Manual for instructions on the proper use of this equipment. Failure to follow the appropriate Operator's Manual when using our equipment or to otherwise act irresponsibly may result in serious injury or death. The only warranty applicable to our equipment is the standard written warranty applicable to the particular product and sale and Terex makes no other warranty, express or implied. © Terex Corporation 2023. Terex, the Terex Crown design, Fuchs and Works For You are trademarks of Terex Corporation or its subsidiaries.

Fuchs USA | 11001 Electron Drive | Louisville, KY 40299 | USA | Phone: +1 610-763-7867 | sales.fuchsusa@terex.com

